

# Diebolt & Company

## Product Notes & Specifications

### Hose Fittings

Figure 1. Male Pipe

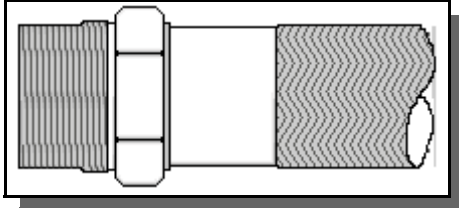


Figure 2. Female JIC Swivel

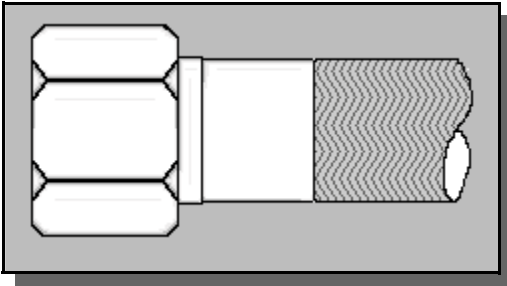
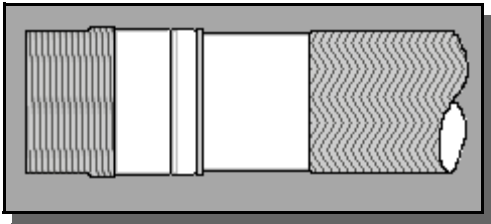
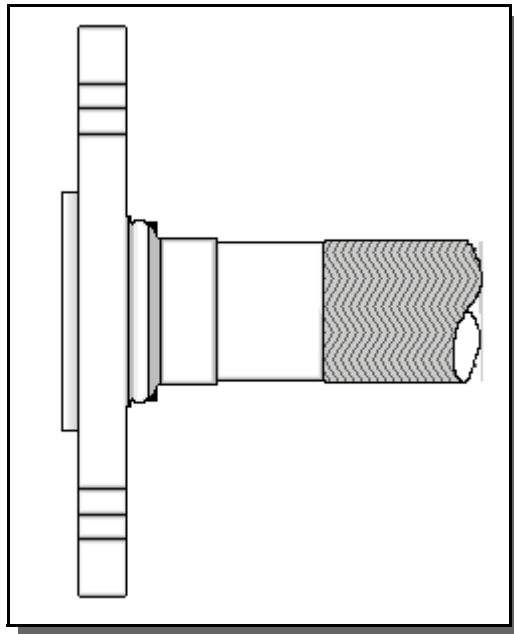


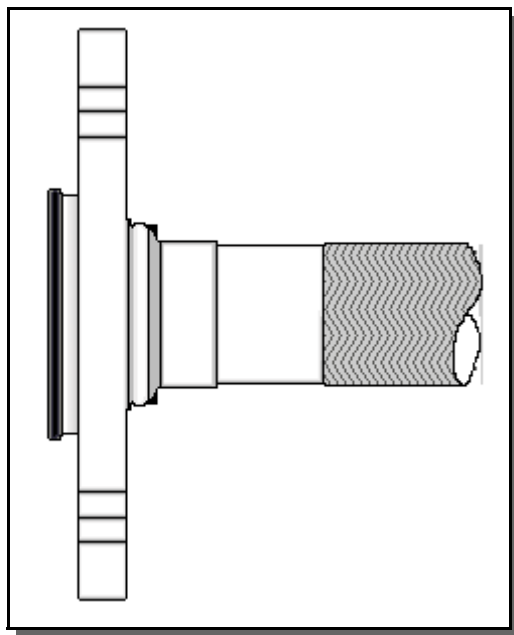
Figure 3. Male Pipe No Hex

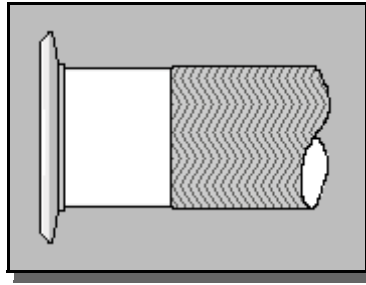


**Figure 4. Flange Retainer**



**Figure 5. Teflon Lined Flange Retainer**



**Figure 6. Sanitary Fitting Tri Clamp Style****NOTE**

Male pipe fittings and female swivel inserts and heater hose fittings are available in carbon steel and Type 316 stainless steel. Flange retaining inserts are available in Type 316 stainless steel braided hose and fittings - either plain or teflon lined. Collars are either carbon steel or 304 stainless.

**Table 1: Medium Pressure Smooth Bore Teflon Male Pipe Fittings**

HOSE SIZE	THREAD	NOMINAL ID. (INCHES)
3	1/8-27	0.95
4	1/4-18	0.156
5	1/4-18	0.207
6	3/8-18	0.277
8	1/2-14	0.358
10	1/2-14	0.469
12	3/4-14	0.594
16	1-11 1/2	0.812

**Table 2: Medium Pressure Smooth Bore Teflon Female JIC Swivel Fittings**

HOSE SIZE	THREAD	NOMINAL ID. (INCHES)
3	3/8-24	0.95
4	7/16-20	0.156
5	1/2-20	0.207
6	9/16-18	0.277
8	3/4-16	0.358
10	7/8-14	0.469
12	1 1/16-12	0.594
16	1 5/16-12	0.812

**Table 3: High Pressure Smooth Bore Teflon Female JIC Swivel Fittings**

HOSE SIZE	THREAD	NOMINAL ID. (INCHES)
4	7/16-20	0.139
6	9/16-18	0.244
8	3/4-16	0.342

**Table 3: High Pressure Smooth Bore Teflon Female JIC Swivel Fittings**

HOSE SIZE	THREAD	NOMINAL ID. (INCHES)
10	7/8-14	0.410
12	1 1/16-12	0.518
16	1 5/16-12	0.769
20	1 5/8-12	0.955

---

**Diebolt & Company**

Call 1-800-DIEBOLT (343-2658) or email [sales@dieboltco.com](mailto:sales@dieboltco.com)